

**kanex**

MPN:  
Edge-to-Edge  
Screen Protector  
QSG  
08/23/2016



CMYK



PMS 102



Spot UV



PMS Silver 877



PANTONE 10348C

### Kanex Thank You Insert

Accoridan Fold



Folded Size : 9 cm x 17 cm  
Flat Size : 18 cm x 17 cm



FOLD LINE

THANK YOU  
for your purchase!

**kanex**

**STOP!**  
**DON'T THROW AWAY!**

REGISTER YOUR KANEX PRODUCT AT:  
[KANEX.COM/SUPPORT/REGISTRATION](http://KANEX.COM/SUPPORT/REGISTRATION)



**LIMITED LIFETIME WARRANTY**

Kanex warrants these products against normal wear and tear during the lifetime of the product for which it was purchased set forth by our Warranty Policies. You must register your product at [Kanex.com](http://Kanex.com) and return the damaged product to Kanex at your own will, using your own resources. Kanex, at its option will exchange the product with a product that is of equal value. You will be required to provide a valid Proof of Purchase and Receipt of original purchase to Kanex in a digital and direct manner. Customer is required to pay their own shipping and handling charge for the return of the product and replacement product.

Please make sure your product is registered with [Kanex.com](http://Kanex.com). It is the customer's responsibility to return the damaged product to Kanex within thirty (30) days of receiving the replacement.

For more information about the Kanex Warranty Policies including terms and conditions, please visit:  
<http://www.kanex.com/support/warranty>

Limited Lifetime Warranty applicable only to Kanex UPC Code(s):  
815387020363 (iPhone 7 - Black); 815387020370 (iPhone 7 Plus - Black); 815387020387 (iPhone 7 - White); 815387020394 (iPhone 7 Plus - White); 815387020349 (Note 7 - Silver); 815387020356 (Note 7 - Black); 815387020431 (Note 7 - Blue)

FOLD LINE

**kanex**

MPN:  
Edge-to-Edge  
Screen Protector  
QSG  
08/23/2016

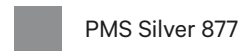

FOLD LINE

## Installation Instructions

Follow these steps to install your new Kanex **EdgeGlass** Edge-to-Edge Screen Protector for iPhone 7 & iPhone 7 Plus.

### Preparation and Cleaning:

The first and most important step to a perfect installation.

- 1 Choose a clean, well-lit environment with a flat surface.

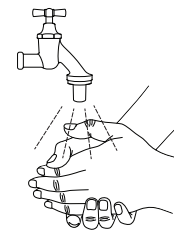

- 2 Wash and dry your hands – Remove dirt and oils.

- 3 Clean your screen – Use the provided cleaning wipe to clean off the entire screen. Then wipe the screen with the microfiber cloth to remove all lint and dust. Use the dust removal tape to eliminate any remaining dust particles. (DO NOT TOUCH THE DEVICE SCREEN ONCE IT'S CLEANED.)

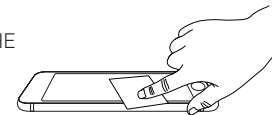

### Alignment:

Perfect alignment can be achieved by following these easy steps.

- 4 Hold the sides of the glass with your fingertips so the protective layer is facing down. Peel off the protective film labeled Step ①. Do not touch the adhesive side once the protective layer is removed.

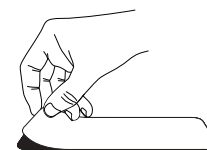

- 5 Slowly lower the uncovered adhesive side to your screen while carefully aligning it with the sides, bottom and home button of your device. If it does not align perfectly, gently lift immediately and adjust until you are satisfied.

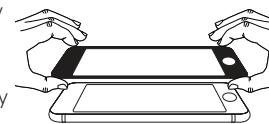

- 6 Once in place, lightly tap the center and slide your forefinger across the middle in the shape of a cross.



### Bubbles:

Easily eliminate bubbles.

- 7 Use your fingers and the microfiber cloth to firmly push bubbles out from the center towards the edges. If a bubble remains, press and hold it for five to ten seconds until it dissipates.

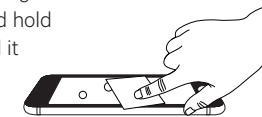

### Finishing Touches:

Last Step!

- 8 Use the microfiber cloth to polish your screen protector and you are ready to go!



### Important Notes:

1. After installing the EdgeGlass, you may see faint wave patterns. This is quite common and is caused by the adhesive and bonding of the two glass surfaces together. This will disappear after 24-48 hours.

2. Although this product is made from tempered glass, please use caution by avoiding strong impact or bending.

3. Whether broken or intact, use caution when removing the EdgeGlass from your device and keep out of the reach of children.

4. Please do not remove your EdgeGlass Screen Protector for the purpose of re-installing it, as it is a one-time use product. Only remove the EdgeGlass when discarding or replacing.

Don't forget to register your product!  
Visit: <http://www.kanex.com/support/registration>

For further installation assistance, please contact our technical support: <http://www.kanex.com/contact/techsupport>

FOLD LINE